

Fosroc Lokfix E Application Guide

The Application of Lokfix E products is relatively simple but should be undertaken carefully and in close accordance with the designers instructions. Incorrect preparation or application can lead to failure. The following is a brief overview to the application process into hollow block. For full details consult the application method statement specific to the material you have selected and the substrate into which you need to fix.

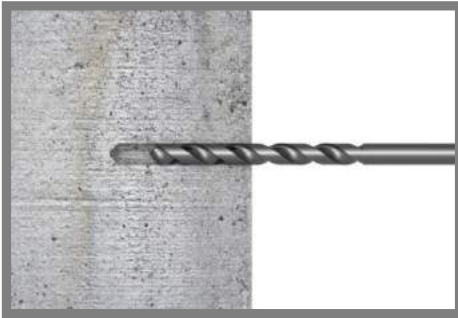

1. Create the Hole

Having selected the fixing type and designed the correct depth and diameter using the respective Lokfix E TDS, create the hole using a rotary percussion or hammer drill.

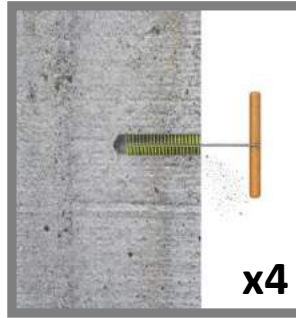

2. Brush Clean

Select the correct brush for the application ensuring the bristles meet the hole diameter and the brush can reach the bottom of the hole (use handle extensions if necessary). Brush out debris four times

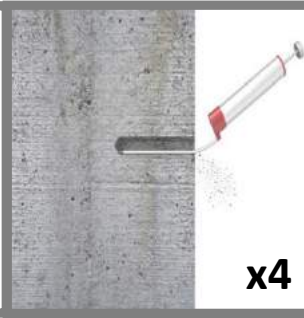

3. Air Clean

Using a blow pump or a oil free compressed air lance, blow out debris from the hole four times. If the hole is wet, use air to dry it. Pay attention to changes in setting and curing times.

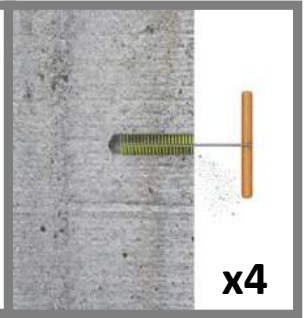

4. Brush Clean

Brush out debris four more times. If there is visible dust at the end of this process, repeat air and brush cleaning until it is gone. Ensure there is no oil, grease or dust contamination in the hole.

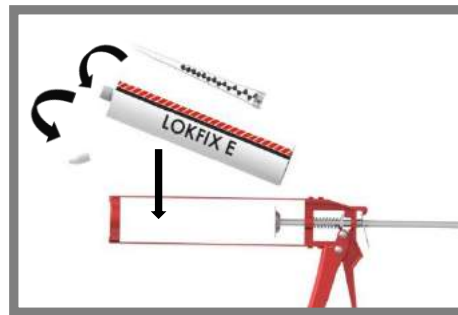

5. Prepare the Cartridge

Unscrew the plastic cap (may be retained if you wish to re-use the cartridge). Using a knife cut the plastic sack beneath the metal clip and discard. Screw the mixer nozzle onto the cartridge. Place the cartridge in the application gun.

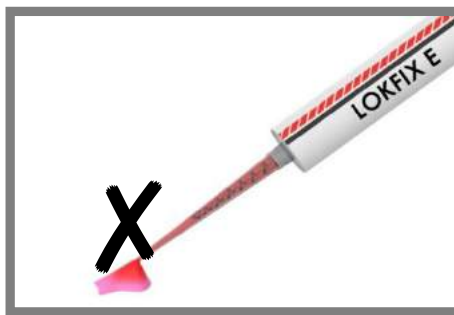

6. Pre-mix

The initial extrusions of resin are NOT suitable for use and must be discarded. Extrude resin from the nozzle until a consistent colour is achieved. Colour may be compared to mixed colour patch on cartridge label. Discard unmixed resin in accordance with local regulations.

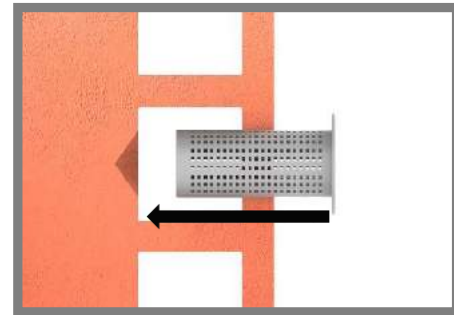

7. Hollow Block Sleeve

Insert the hollow block sleeve into the hole ensuring a tight fit and that the sleeve is flush with the wall face .

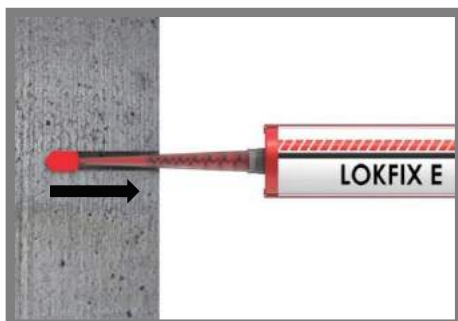

8. Resin Application

Insert the nozzle to the back of the sleeve and apply Lokfix. Draw the cartridge slowly back out of the hole until it is full. Close the lid of the sleeve.

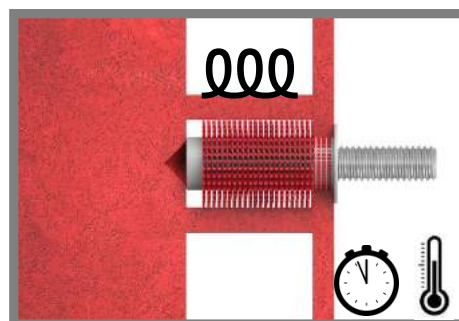

8. Fixing Application

Insert the fixing into the hole using a twisting motion, setting the fixing in the centre of the hole. Resin should extrude from the sides of the sleeve creating a bloc that will plug the fixing and sleeve in place. Pay close attention to application temperatures and time to ensure this is done within the setting period.

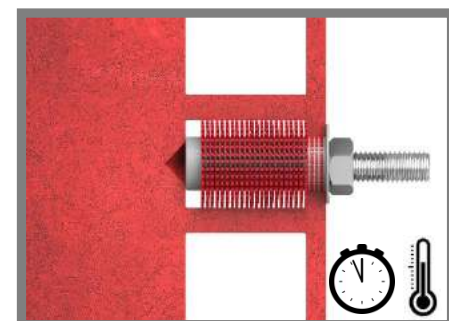

9. Loading

Do not touch or adjust or load the fixing during the curing period. Pay close attention to application temperatures and time. Wet Areas will take longer to cure. Once set has been achieved the fixing may be loaded. Take care not to over-tighten nuts.